

Michigan Math Club

Meeting [virtually](#) for Fall 2020
Thursdays at 4pm EST



You Spin Me Right Round, Baby: The Conway-Radin Pinwheel Tiling



Timothy Goldberg
Lenoir-Rhyne University

03 December 2020

The pinwheel tiling of Conway and Radin is a captivating and easy-to-build tiling of the plane that is non-periodic but still contains symmetry. It also makes a truly dizzying coloring sheet! In this talk, we will describe the construction of the tiling and discuss some of its properties. This will include many examples of mathematical art related to and inspired by the pinwheel tiling.

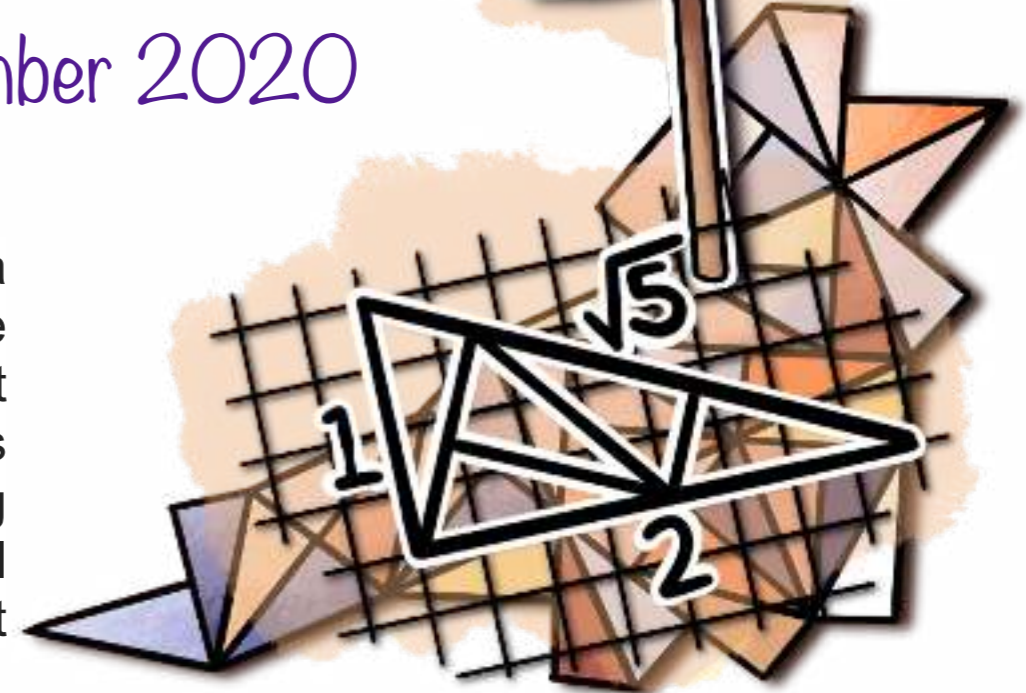

Artwork made by Moira Armstrong